



Indiana Percussion Association
2011 State Finals Information for
Parents, Students, and Staff

PLEASE SHARE THIS INFORMATION WITH EVERYONE IN YOUR GROUP
SO THAT EVERYONE HAS A BETTER STATE FINALS EXPERIENCE.

Check In: ALL of your performing members and any crew/parent volunteers that wish to be included in the free passes included for every unit must check in **AT THE SAME TIME**.

Ticket Prices: Ticket prices are set by IPA, and are determined by the cost of judges, trophies, and all of the other expenses in planning and producing the culminating event for our association. Ticket prices are: \$10.00 for adults, \$5.00 for students and senior citizens. Optional backside seating is available for crew members (\$5.00, only available at time of unit check-in).

Warm-up Time: Your warm-up time is the time you have to enter, warm-up, and exit the room. (A-Class 18 minutes, Open Class 20 minutes, World Class 22 minutes).

You may be allowed to enter the room early, or it is possible that the contest may run behind and you don't get in to warm-up until after your warm-up time was to begin. You will be allowed the full amount (18/20/22) provided you are ready to move into the warm-up area when it is available.

You may be asked to move into the warm-up room earlier than what is on the schedule. This is done so that the contest continues to flow smoothly. It does not mean you get extended time in warm-up. Your consideration and flexibility with warm-up is greatly appreciated.

Finally,

New to IPA this year is a LIVE WEBCAST of the IPA State Championships on www.indianapercussion.org. Please share this website with your students, parents, boosters, etc... so they can be a part of the show too!

Thanks very much for your flexibility and cooperation with these different issues.

Sincerely,

The IPA, inc. Executive Board of Directors



Indiana Percussion Association
2011 State Finals

Ben Davis High School

1200 N. Girls School Rd., Indianapolis, IN 46214

Band Office - 317-243-5523 (Contest Headquarters)

Dusty Pettit 317-440-9278, Gary Rudolph (day of contest) 317-513-3219

Congratulations for your success at Indiana Percussion Association State Prelims. IPA and Ben Davis High School are excited to host 2011 State Championships. Please take a few moments to familiarize yourself with the following information:

Check-in: Check-in is located at door 21 on the north side of the building. All participants, parent helpers and staff should check-in together. Please remember that you are allowed only 8 free tickets plus your 5 staff/driver badges. All others must be paid for! IPA sets the cost of admission. Please have your Performing Members Declaration and Video Order Form completed before you arrive at check in.

Ticket Prices: \$10.00 Adults, \$5.00 for Students/Senior Citizens (children under 6 are free).

Homerooms: There are homerooms available for this contest. Please report any problems you may have to the check-in desk. Please do not leave trash in the homeroom after you exit – we will be using these rooms for other groups today.

Parking: Bus and truck parking is in the north lot (see map). Staff may also park in this lot. Spectator parking is on the south and east sides of the building.

Equipment and Props: Unloading and loading will take place in the west lot of the school, between the school and the football field.

- There is no access to a loading dock for this event.
- The equipment/props entrance is located at the west side of the field house (see map).
- Everyone entering the field house MUST have a hand stamp.
- You can move your equipment into the field house about 1 hour before your warm-up.
- We will be using “lanes” in the unloading area.
- Please, NO PLAYING in the field house and, be sure all props are padded/taped.

Hospitality: we will have staff hospitality located in Le Gallery, in the north wing of the building. Driver hospitality is located near Le Gallery in room E114. (see map)

Contest Headquarters: is located at the Announcer’s Table, upper SW corner of the gym.

Warm-ups: Warm-ups will be done the same as last year—utilizing a large band ensemble room, and a separated area of the field house. Props will be placed *just past* the warm-up rooms down Q Hall.

Outdoor Warm-ups: You may also warm-up outdoors, weather permitting, prior to (or instead of) your official warm-up. The marching band rehearsal field is right outside the field house (MPA), and is very convenient in terms of flow to the official warm-up area, and the performance area. Each group is responsible for getting back inside the building on time. Your guide is not responsible for you if you are outdoors.

Performance: The performance area for today's event is 60' x 80'. The actual space in the gym is 80' x 108'. The boundary and timing lines will be clearly marked.

Performance Entrance: The groups will enter the performance area (as the judge sees it) from the upper right hand corner of the gym. There will be 2 sets of double doors you may enter through. Tarps should be folded back to front (again, as the judge looks at it).

Time Line / Exit Line: Horizontal Time Line. The total performance time will stop once a group crosses the half-way line from front to back or "basket to basket" (the same as state finals 2002 through 2010). You will exit at the lower right front of the gym. Please be mindful of the front sideline!

Performance Exit: The units will exit the performance area (as a judge looks at it) from the lower right doors. The exit also has 2 double doors with no bars. Once the unit is out of the gym, PLEASE STAY TO THE RIGHT.

Tarp Re-folding: Tarps may be refolded in the field house. We ask that each group load within 30 minutes of the end of your performance.

Awards Ceremony: Awards will happen in full Olympic-style retreat. Performers will be asked to meet in "R" hall, which is just outside the gym when you exit the performance. Please discuss "Proper" behavior with your students prior to them gathering for retreat. (To be blunt, no moshing!)

Concessions: Concessions are available in the cafeteria.

Judges: IPA has provided the double panel of judges for this event. Critique at this event is for groups going on to WGI World Championships ONLY. Judges sheets will be distributed during the awards ceremony to your student captains. Digital Commentary CD's of your unit will be available at the announcer's desk prior to the awards ceremony.

Have a great day and good luck!

The Indiana Percussion Association and Ben Davis High School; contest hosts.

Performing Members Declaration

Please Complete Prior to Check In!

March 19, 2011

Unit: _____ Director: _____

Class: PSCA PSA PIA PSCO PSO PIO PSCW PSW PIW

Number of Performing Members on the Floor: _____

Signed: _____ Title: _____ Date: _____

DVD Order Form

IPA State Finals at Ben Davis HS
Saturday, March 12th, 2011



IM Video Productions will be providing a high-quality DVD of each performing unit at the IPA State Finals being held at Ben Davis High School on March 19, 2011. Each DVD comes with a standard DVD case, high quality color insert, and a custom printed DVD featuring a 16:9 Widescreen (HD Source) version of each performance.

We will also have floor and pit mics in use for all of the unit performances. This will ensure high quality sound reproduction for all units. Each DVD is just \$15, and \$10 for any additional copies.

ALL ADDITIONAL COPIES WILL BE MAILED PROMPTLY ON MONDAY AFTER THE CONCLUSION OF THE EVENT AND WILL STILL INCLUDE ALL OF THE ABOVE. These single performance DVD's will not be available for sale to the public after the event, so please process all desired orders for your group on this Director order form.

If you would like to purchase a Director DVD(s), please print this sheet and fill out the information below. You will turn this in at unit check-in the day of the show.

Unit Name: _____

Contact Name: _____

Contact Phone: _____ Email: _____

Mailing Address: _____

State, City, Zip: _____

Number of DVD Copies: _____ (\$15 for first, \$10 for additional copies)
Please make all checks payable to "IM Video Productions"

To be used by unit check-in staff:

Amount Received: _____ **Check Number:** _____ **Cash:** _____

Map to Ben Davis High School

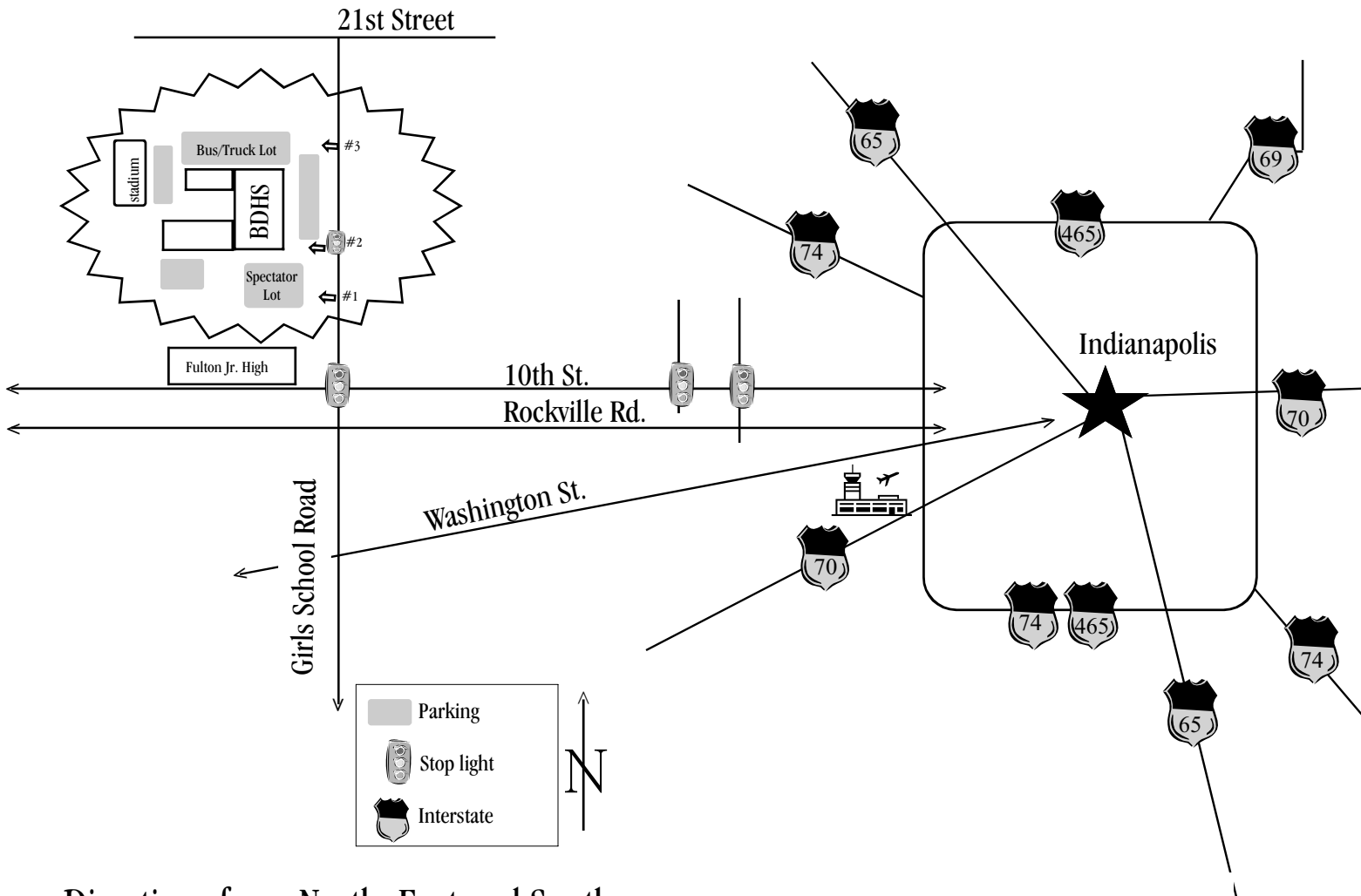

Directions from North, East and South:

Take 465 to West 10th Street exit. Go West on 10th Street to the third traffic light, this is Girl's School Road. Turn right onto Girl's School Road. Ben Davis High School is located on the left-hand side of the road. The 3rd entrance into Ben Davis takes you into the North parking lot for trucks and buses..

Directions from West:

Take Washington Road (Rockville Road or 10th St.) West towards downtown Indianapolis. Turn left onto Girl's School Road. Ben Davis High School is located on the left-hand side of the road just past 10th Street. The 3rd entrance into Ben Davis takes you into the North parking lot for trucks and buses.

Map of Ben Davis Winter Percussion State Finals

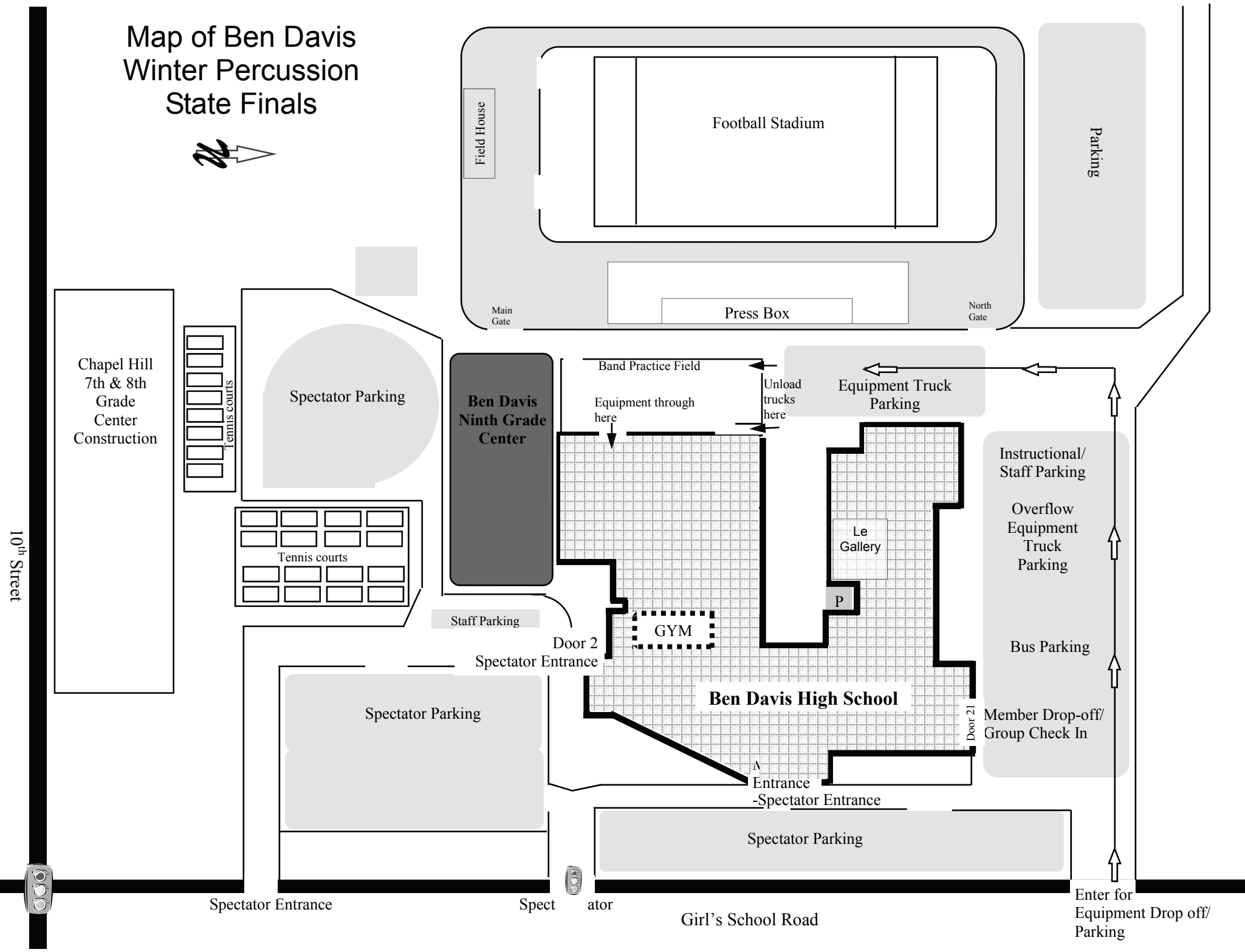

10th Street

Spectator Entrance

Spectator

Girl's School Road

Enter for Equipment Drop off/ Parking

Ben Davis High School

Flow for IPA State Finals

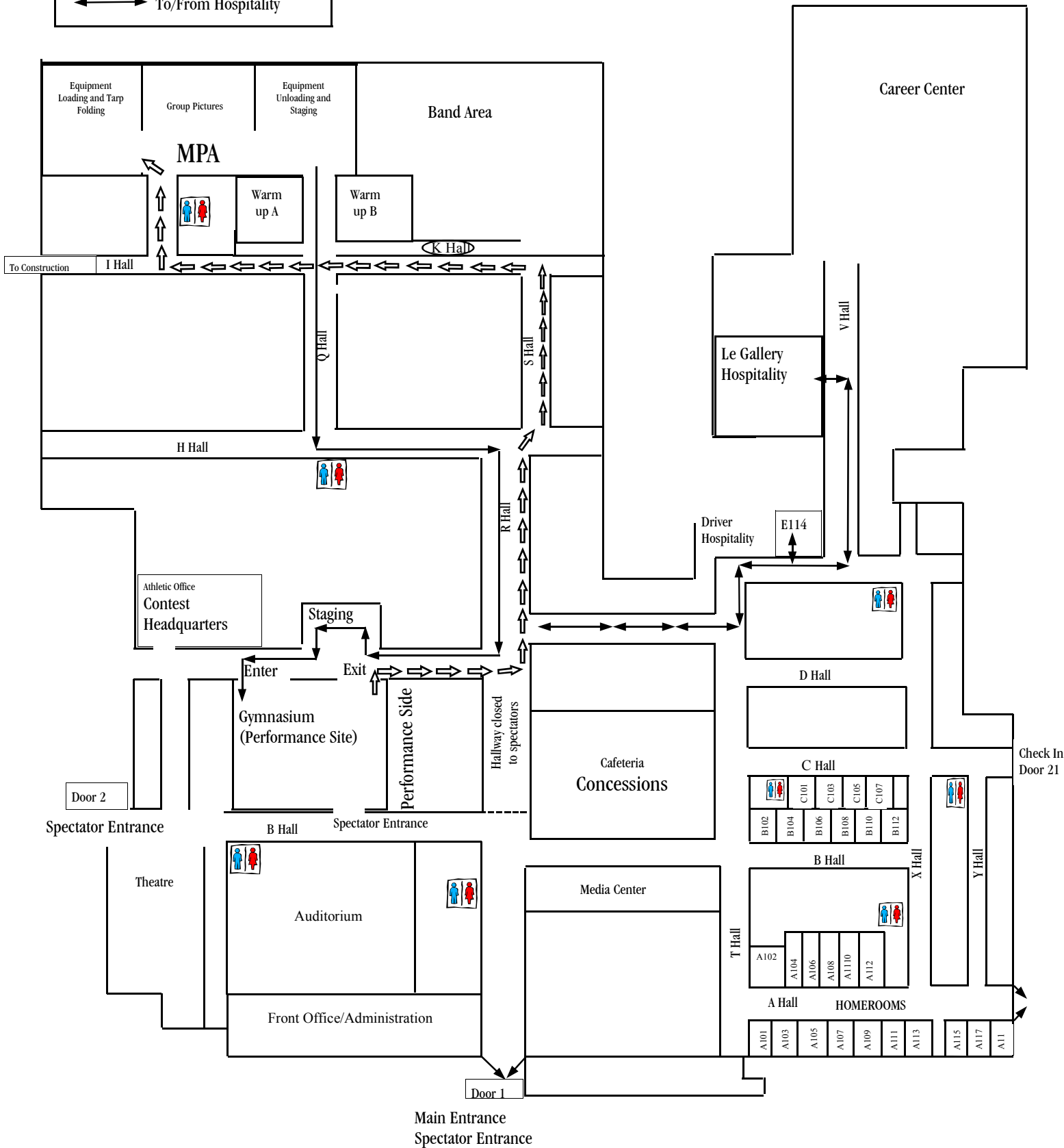
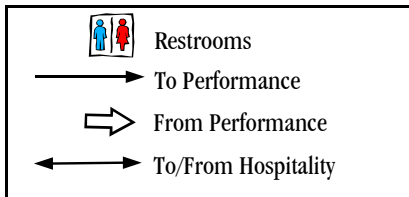

~STATE FINALS PERFORMANCE AREA INFO~

Rule 7.7 States that “All personnel, equipment, and/or props must be off the contest floor, clear of the 50/50 line at the conclusion of the interval time. For purpose of timing, equipment and props are considered removed when they have been moved across a center line either horizontal or vertical depending on the contest site. After the equipment/props have crossed this line, they must be removed from the area immediately and taken to an area designated by the Contest Director. Failure to remove equipment and props to the designated area in a timely manner is subject to a penalty at the discretion of the Contest Director. Backside and sideline usage will be at the discretion of the contest director, as defined by the facility.”

AT THIS CONTEST THE TIME LINE WILL BE
“HORIZONTAL”
FROM BACK TO FRONT

*Electrical power will be provided via 50', 12 gauge extension cords located at the front center and rear center of the Competition Area (per Rule 3.7).

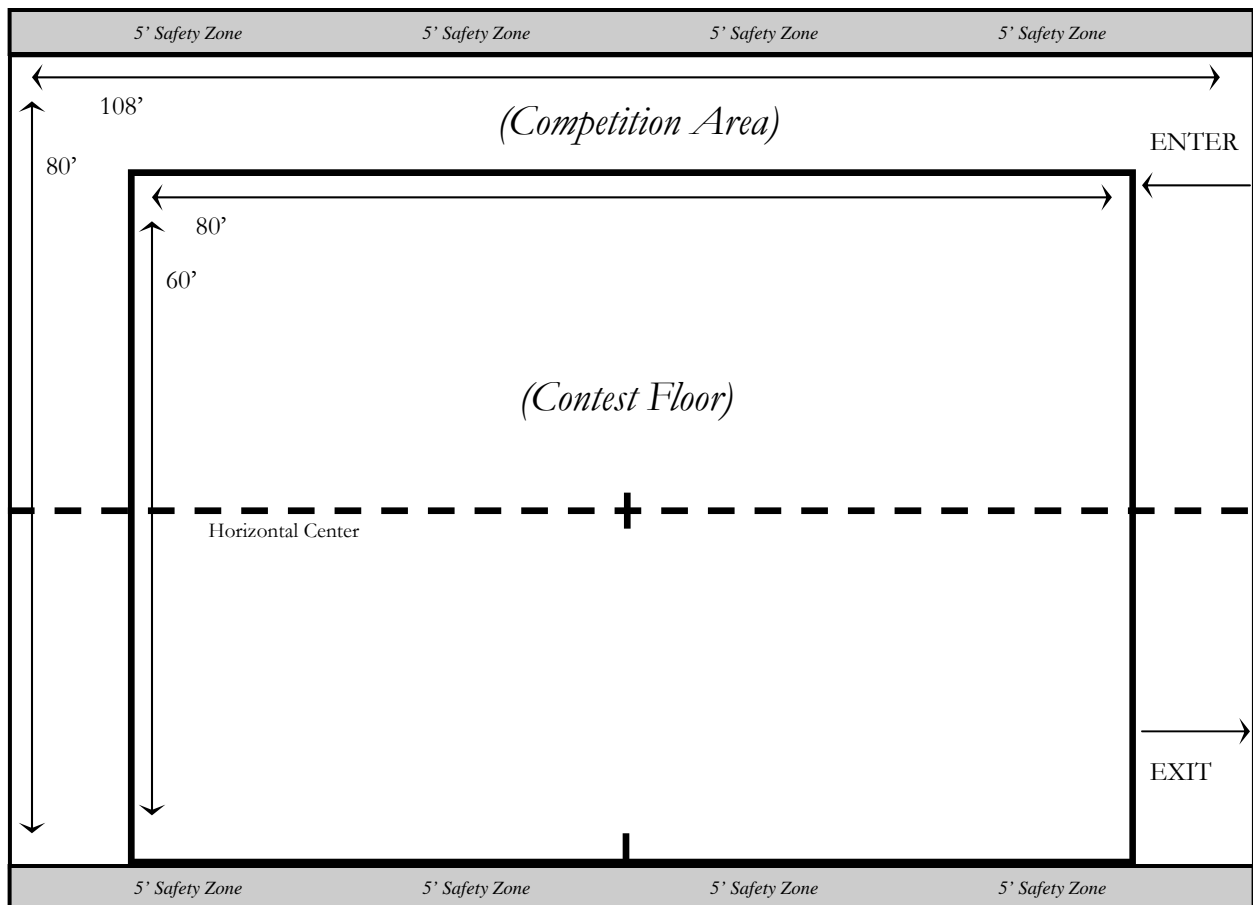

Judges/ Spectators Seating



IPA Spring Meeting 2011

Saturday, April 23rd- 9:00 AM-1:00 PM

ISSMA Office

100 E Thompson Rd.

Indianapolis, IN 46227

Topics to include:

- Reassignment Procedures for 2012
- PSAA Class vs. PSA Class Discussion
- Election for IPA President-Elect and Secretary
- Judge's surveys
- 2011 Wrap-up
- 2011 IPA Clinic Day
- Items from the floor

Make your voice heard... please make plans to attend the 2011 IPA Spring Meeting!



Digital Commentary “Acceptable Use” Policy

The Digital Commentary provided at this event is a reflection of the adjudication provided to your ensemble at this contest. The content of that commentary is for the sole, private use of the unit’s staff for educational purposes. Therefore, any commentary provided may not be made available for public use via email or website for any reason at any time. Your careful adherence to this policy will allow the IPA to continue to provide such highly regarded adjudicators.

Thank you,
The IPA Executive Board of Directors



Digital Commentary “Acceptable Use” Policy

The Digital Commentary provided at this event is a reflection of the adjudication provided to your ensemble at this contest. The content of that commentary is for the sole, private use of the unit’s staff for educational purposes. Therefore, any commentary provided may not be made available for public use via email or website for any reason at any time. Your careful adherence to this policy will allow the IPA to continue to provide such highly regarded adjudicators.

Thank you,
The IPA Executive Board of Directors

INDIANA PERCUSSION ASSOCIATION, INC.
2012 CONTEST HOST APPLICATION
MUST BE POSTMARKED BY FRIDAY, MAY 6th

Dear IPA Membership School,

This letter and application is for ALL IPA membership schools, in good standing for the 2011 season that would like to be considered to HOST an IPA Invitational, Prelims, or Finals, for the 2012 season. Some contest hosts will be the same while others will be different. With new schools and members every year, we try to accommodate all regions and consider travel when assigning contest host sites. If you are a NEW CONTEST HOST, you MUST submit a video tape of facilities, warm up areas, contest flow, parking, etc....to be considered! Any school NOT turning in all parts of this application fully completed will not be considered for a 2012 contest host.

Directions

- 1) Fill out application COMPLETELY. *(Any incomplete applications will not be accepted)*
- 2) Please mark your 1st, 2nd, and 3rd choices if you wish to host. If you only have one date, please list that date and explain the reasons that is the only date.
- 3) The BAND DIRECTOR, SCHOOL PRINCIPAL, and FACILITIES DIRECTOR/ATHLETIC DIRECTOR must sign this application stating that these are open dates to host an IPA event for the 2011 season. Many shows must start close to noon, and most do not end until around 9pm, so please make sure there are no athletic events, musicals, plays, etc which will interfere with the warm-ups, performance venues, or contest flow.
- 4) Any school wishing to host MUST have removable posts entering and exiting warm up areas and performance areas. This is not optional!
- 5) Any questions, please contact Justin Ramirez, 812-340-0213.

Mail completed applications to:
IPA, Inc.
100 East Thompson Road
Indianapolis, IN 46227
Fax to: **(317) 780-4110- ATTN: IPA**
Email to: secretary@indianapercussion.org

INDIANA PERCUSSION ASSOCIATION, INC.
2012 CONTEST HOST APPLICATION
MUST BE POSTMARKED BY FRIDAY, MAY 6th

School Name: _____

Address: _____ City: _____ Zip: _____

School Phone: (____)____ - _____ Home Phone: (____)____ - _____ Cell Phone:(____)____ - _____

Email address you will be checking over the summer: _____

~~~~~ POSSIBLE DATES AVAILABLE FOR THE 2012 IPA CONTEST SEASON ~~~~~

-----

\_\_\_\_\_ *Feb 4 –Invitational*

\_\_\_\_\_ *Mar 3 - Invitational*

\_\_\_\_\_ *Feb 11 –Invitational*

\_\_\_\_\_ *Mar 10 – Invitational*

\_\_\_\_\_ *Feb 18 –Invitational*

\_\_\_\_\_ *Mar 17 – IPA State Prelims*

\_\_\_\_\_ *Feb 25–Invitational*

\_\_\_\_\_ *Mar 24 – IPA State Finals*

*\* Please indicate your top 3 preferences and place an X on any other date your school is available to host.*

-----

Have you hosted an IPA event before? If yes, what and when: \_\_\_\_\_

\_\_\_\_\_

Please list any pageantry events that your organization has hosted:

\_\_\_\_\_

\_\_\_\_\_

Does any UNIT have to go outside after unloading in order to warm up/perform? \_\_\_y \_\_\_n

Does the performance exit lead to outside? \_\_\_\_\_yes \_\_\_\_\_no

Please list the amount your gymnasium hosts on the “concert” side: \_\_\_\_\_

Are there steps involved in the equipment flow of this contest? \_\_\_yes \_\_\_no

If yes, please explain: \_\_\_\_\_

\_\_\_\_\_

---

INDIANA PERCUSSION ASSOCIATION, INC.  
2012 CONTEST HOST APPLICATION  
MUST BE POSTMARKED BY FRIDAY, MAY 6<sup>th</sup>

-----

Are all bars removable entering all warm ups and performance areas? \_\_\_\_ yes \_\_\_\_ no

If no, Please explain: \_\_\_\_\_

\_\_\_\_\_

When bars are removed in the performance area, what are the door measurements? \_\_\_\_\_

Will your school be under construction for the 2012 season? \_\_\_\_ yes \_\_\_\_ no

If yes, please explain: \_\_\_\_\_

\_\_\_\_\_

How many warm up areas do you have that are available to you that day? \_\_\_\_\_

In detail, please describe those warm up facilities: \_\_\_\_\_

\_\_\_\_\_

\_\_\_\_\_

Please describe the loading and unloading areas of your contest

site: \_\_\_\_\_

\_\_\_\_\_

Does your school have wi-fi available to the IPA Board? \_\_\_\_ yes \_\_\_\_ no

Does your school have wi-fi available to the general public? \_\_\_\_ yes \_\_\_\_ no

***If this is your first time to host an IPA event, please make sure to enclose video as per directions stated on page one of this application. The application will not be considered if not accompanied by video.***

INDIANA PERCUSSION ASSOCIATION, INC.  
2012 CONTEST HOST APPLICATION  
MUST BE POSTMARKED BY FRIDAY, MAY 6<sup>th</sup>

-----

*I, \_\_\_\_\_, do hereby guarantee that the contest dates submitted*  
(band director)  
*have been cleared on the school calendar by the high school principal and high*  
*school athletic director/facilities director. I understand that if these dates are*  
*assigned and then have to be changed, this affects all the IPA Contest Hosts and*  
*scheduling of the 2012 Contest Season, and we may lose consideration as a host*  
*for the 2012 season.*

|                                                     |        |
|-----------------------------------------------------|--------|
| _____                                               | _____  |
| (band director's signature)                         | (date) |
| _____                                               | _____  |
| (administrator's signature)                         | (date) |
| _____                                               | _____  |
| (athletic director's/facility director's signature) | (date) |

**ALL CONTEST HOST APPLICATIONS MUST BE  
POST MARKED ON OR BEFORE:  
FRIDAY, MAY 6<sup>th</sup>!**

**Please Mail, Fax, or Email Applications to:**

Mail completed applications to:  
**IPA, Inc.**  
**100 East Thompson Road**  
**Indianapolis, IN 46227**

Fax to: **(317) 780-4110- ATTN: IPA**

Email to: [secretary@indianapercussion.org](mailto:secretary@indianapercussion.org)

Please direct all questions to Justin Ramirez- 812-340-0213